

# CHRISTMAS TREE FESTIVAL



9th, 10th & 16th December 2023  
St James Church, Nayland



# NAYLAND CHRISTMAS TREE FESTIVAL

Nayland saw its first Christmas Tree Festival in 2023 which remained in situ until twelfth night.

Twenty six organisations, almost exclusively associated with Nayland, came together to decorate their tree in the theme of their organisation. The results were magnificent with imagination and creative skills seen in abundance. A wonderful addition to the festival were the Nayland Handbell Ringers who gave a magical performance on the Sunday afternoon.

Those who were able to come along to the Festival very much enjoyed the sight of all these beautifully decorated trees with some children (and a few adults) participating in the Christmas tree trail to find the answers on the trees to the questions supplied by each organisation.

Refreshments were available over the weekend of the 9th and 10th December and a pop up cafe on the 16th December where thanks go to the Anchor for providing and serving mulled wine and mince pies.

A huge THANK YOU must go to our sponsors of the event, Mill Street Stores, Gladwins Farm, Studio B, The Crown, The Anchor Inn, St James' Coffee Morning, Nayland Dental Practice and Churchill Brothers, all the brilliant bakers in the village, all those who kindly came along to help with refreshments and to all the organisations who took part in the event.

The weather wasn't kind to us, visitor numbers were low but it was possible from the monies raised to support the specific project being undertaken at Nayland Primary School with the balance donated to St James' Church.



# CHRISTMAS TREE FESTIVAL

9th, 10th & 16th December 2023



St James Church, Nayland CO6 4JE

Saturday 9th from 10am - 4pm - Sunday 10th from 11am - 4pm  
Refreshments will be available.

On Sunday 10th at 1pm Nayland Handbells Ringers will perform.

On Saturday 16th from 10.30am - 3.30pm there will be  
a pop up cafe serving mulled wine, beverages, mince pies and biscuits.

Christmas tree trail - work out the answers to the questions for each tree.

Christmas trees will be left in place until twelfth night.

Admission Free with donations to  
Nayland Primary School and St James' Church



The concept of holding the first Christmas Tree Festival in Nayland was mooted and taken forward by Karen Freeman.

Local societies, organisations and businesses were invited to participate by decorating a tree to represent their activities or trade. Some businesses kindly contributed by being sponsors which covered the cost of purchasing the trees. The Christmas trees with roots were purchased from Fred Smith of Boxted.

The Festival opened for the weekend of 9th / 10th December; the church was a hive of activity leading up to this with members of the groups and businesses creating their individual themes and decorating their trees. The imaginative creations were spectacular. To give a little extra interest there was a Christmas tree trail where visitors had to work out the answers to the questions for each tree.

Meanwhile, other residents were busy producing a wonderful array of cakes and edible delights; which looked and tasted delightful. The usual band of volunteers came along and did a magnificent job of serving the refreshments.

Mulled wine and wonderful mince pies were provided by The Anchor on 16th December.

On the afternoon of 10th December the Nayland Handbell Ringers came along to ring for visitors; it was magical as they and everyone else thoroughly enjoyed the performance. Thanks were due to Hazel Gardiner for arranging this.

The Christmas trees stayed in place until the twelfth night so those who were not able to attend during the Festival itself could still enjoy the displays.

The event made a surplus of £600 which was split between Nayland Primary school and the St James' Coffee Morning.



# NAYLAND CHRISTMAS TREE FESTIVAL

## Exhibitors

- 1 Friends of St James
- 2 Nayland Village Lunch
- 3 St James' Coffee Morning
- 4 Bellringers
- 5 Friends of Caley Green
- 6 Church Flower Arrangers
- 7 Nayland art group
- 8 Nayland Cinema
- 9 Community Council
- 10 Nayland Choir
- 11 Handbell Ringers
- 12 Woodland Corner
- 13 Nayland Primary School
- 14 Baby & Toddler Group

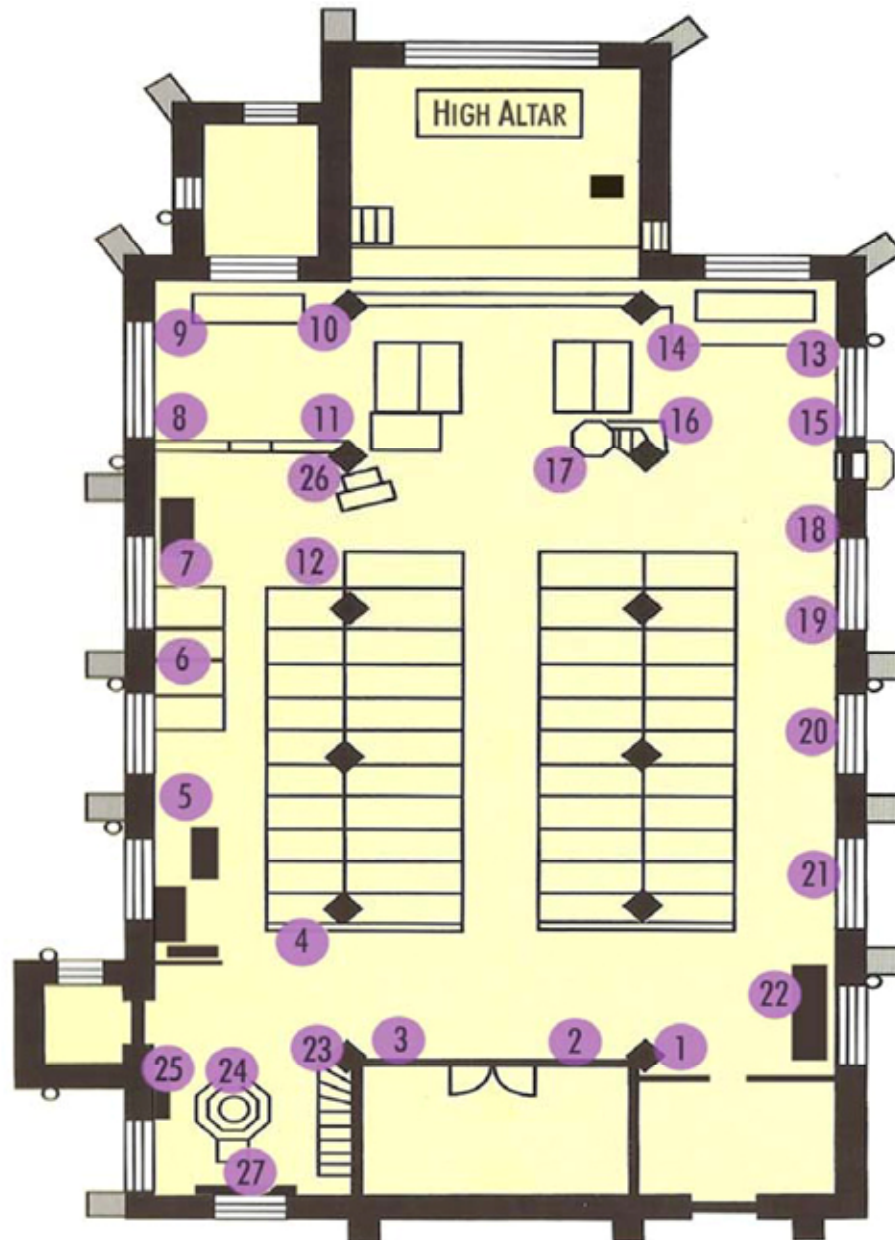

## Exhibitors

- 15 Nayland First Responders
- 16 Jo Metson
- 17 Nayland Firefighters
- 18 Wiston Church
- 19 Family@Nayland
- 20 Nayland Book Club
- 21 Royal British Legion
- 22 Conservation Society
- 23 Nayland Womens' Institute
- 24 Littlegarth School
- 25 Stoke by Nayland Primary School
- 26 St James' Christmas tree
- 27 Horticultural Society

Just a few comments by visitors and participants:

"It was good to see so many organisations contribute; all the trees were so carefully thought out and beautifully decorated. I hope this event becomes a regular fixture."

"The Christmas trees were stunning... of course we had some cake... would've been rude not to! ☺"

"There were many very pretty trees on display at the Festival; a first rate cuppa too. ☺"

"The Christmas trees looked spectacular and were created with much imagination. Striking paper chains and stars made from print from Nayland Primary School; Nayland Choir's fabulous origami decorations made from old sheet music; Nayland Playgroup and the wonderful Gingerbread Man!"

"Our volunteers put their creative heads together to give our tree a distinct look; and we all thoroughly enjoyed it!"

"It was a truly lovely community event; uniting all the village groups and providing a wonderful display for visitors. Many thanks to Karen and her team of helpers."







1 Friends of St James' Church



2 Nayland Village Lunch





3 St James' Coffee Morning





4 St James' Bellringers





5 Friends of Caley Green





6 Church Flower Arrangers





7 Nayland Art Group



8 Nayland Cinema





9 Nayland with Wissington Community Council





10 Nayland Choir





11 Handbell Ringers





12 Woodland Corner – Nayland Playgroup





13 Nayland Primary School









15 Nayland First Responders







17 Nayland Firefighters





18 St Mary's Church, Wiston









20 Nayland Book Club





21 Royal British Legion









23 Nayland Womens' Institute









25 Stoke by Nayland C of E Primary School & Nursery





26 St James' Christmas Tree





27 Horticultural Society

























Many thanks to the merry band of helpers who produced and served a wonderful array of edible delights throughout the Festival.

